

Commercial Doorsets



George Boyd

ARCHITECTURAL IRONMONGERY
& COMMERCIAL DOORSETS





Introduction

Doorset Solutions	04
Why Doorsets?	06
The Flexible Modular Approach	07

Our Customers **08**

Product Range

Veneered Timber Doorsets	10
Laminate Faced Doorsets	12
Additional Doorset Types	13
Door Dimensions and Diagrams	14
Ironmongery for Timber Doorsets	16
Glazed Steel Profile System	18
External Steel Doors	20
Sound Reduction	21

Technical Support **22**

Environmental Commitment **23**

Introduction

Modular Doorsets

This range of Doorset solutions has been introduced to meet the changing needs of the built environment.

Our range of modular solutions provide standardised sizes and performance specifications, whilst retaining the specifier's ability to choose from a wide variety of surface materials, styles, finishes, and architectural details. Doorsets provide improved cost effectiveness and value when compared to more traditional options, whilst allowing the opportunity for architectural flair, so critical to the success of major projects.

Modular Doorsets are installed predominantly in commercial applications. However the same benefits can also be achieved in large private developments.

George Boyd Doorset solutions offer both value for money and choice from the leading architectural ironmongery supplier in the UK. Trading partnerships with a number of quality door manufacturers in Europe and the UK allows us to meet virtually all specifications utilising the best product for the application.

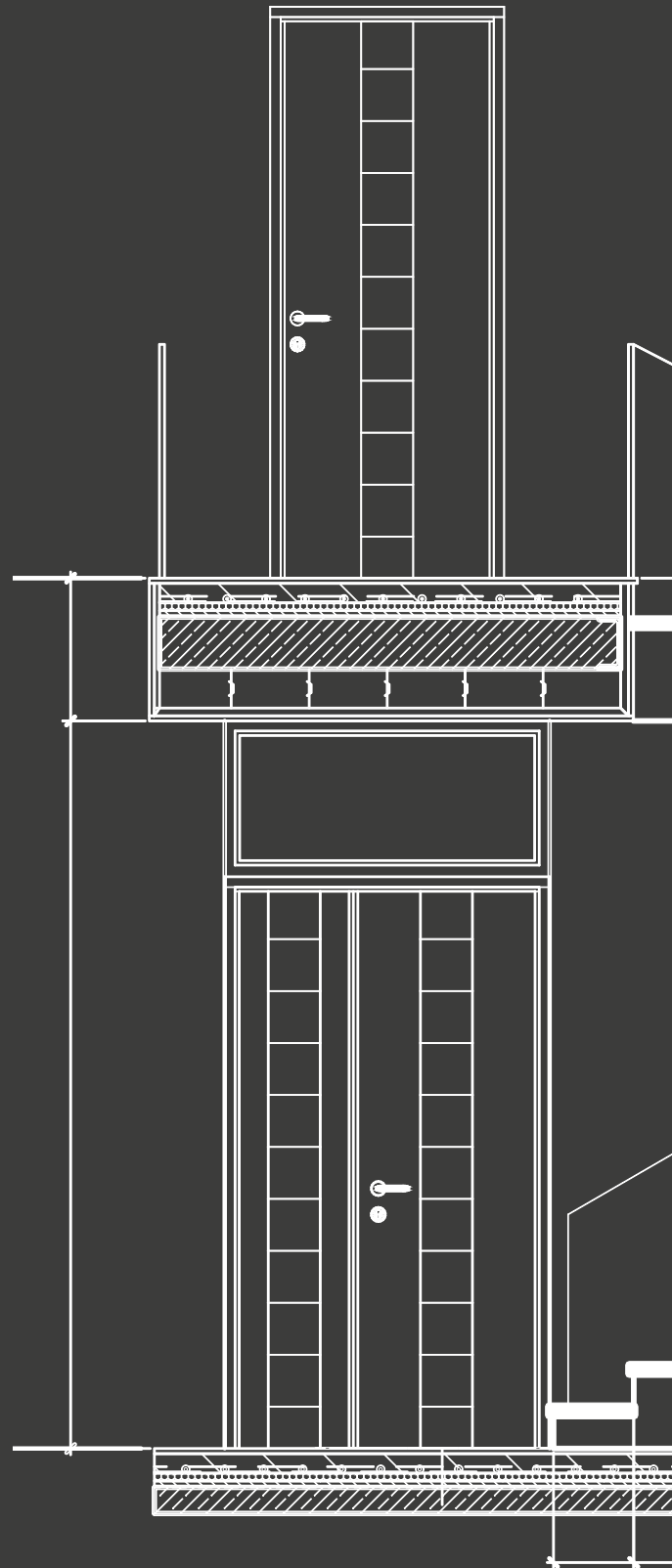

Experience

With a reputation for outstanding design, reliability and service that stretches back over 150 years, George Boyd is the one-stop shop for all of your architectural ironmongery.

Trust

George Boyd are part of Saint-Gobain who design, manufacture and distribute materials and solutions throughout the world.

Services

As a member of the Guild of Architectural Ironmongers, George Boyd are committed to not just reaching, but exceeding our customers expectations.

Our team of qualified sales representatives provide national coverage and will visit your site to ensure that the right specification is achieved.

Doorset Range

- Modular designs
- Non standard designs
- Severe duty core
- FD30, FD60, FD120
- External & internal
- Screens to match
- Ranges of fireglass
- Ranges of finishes
- Range of sizes

Ironmongery Ranges

The complete range of architectural ironmongery is available including:

- Door furniture
- Door closing devices
- Hinges & sliding systems
- Locking
- Escaping (panic latches and bolts)
- Bathroom furniture
- Access controls
- Special needs products
- Ancillary products
- Complex Ironmongery

Standard ironmongery carries our 25-year Guarantee on the lock case and the hinges that come fitted to the Doorset.

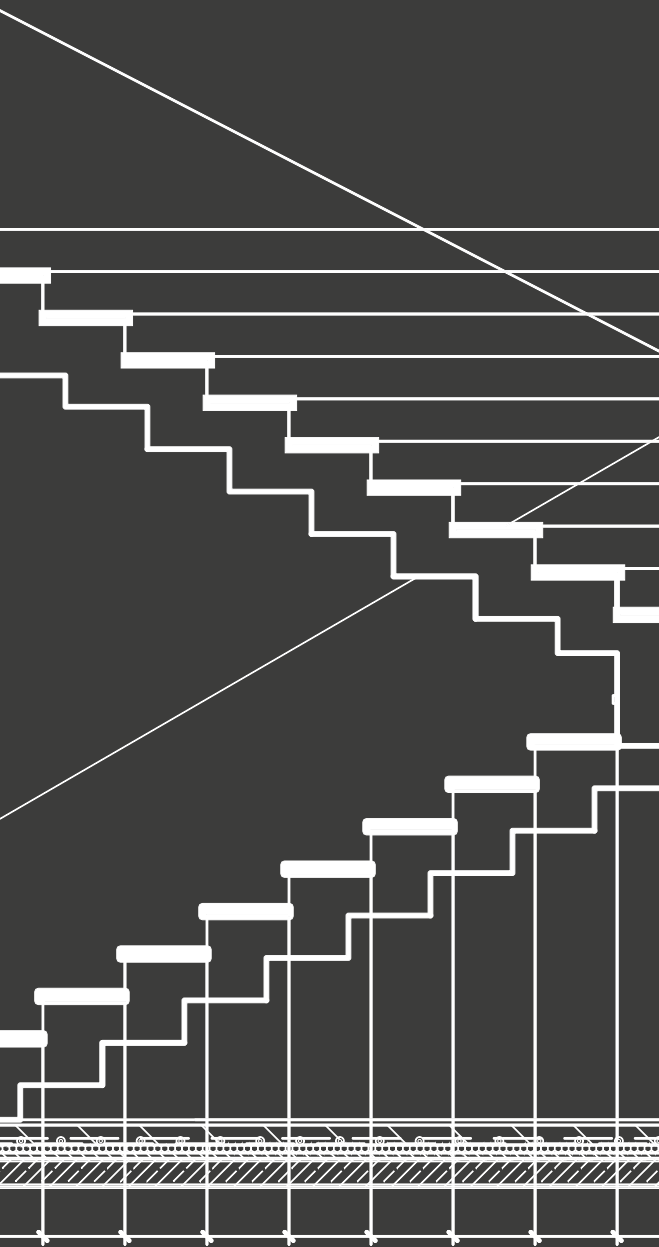

Why Doorsets?

Doorsets have long offered benefits to the architect, contractor and client alike. The new modular approach from George Boyd adds even greater benefits than previously available.

Doorset benefits:

- Complete package; door, frame, ironmongery, seals, vision panels and more, all pre-prepared and ready to use. Additional ironmongery or components are provided to complete the door installation

Faster installation:

- No machine fitting required to hang a door
- Place & fix; fraction of time taken to swing a door by hand

Reduced waste:

- All components finished to size, no material waste
- All parts pre-machined and fitted out

The modular approach:

- One proven, reliable source of supply, the one-stop shop
- Modular range: keeping modules simple reduces risk of error and makes replacements easy
- Tested, approved and certificated as one assembly

Reduced cost:

- Standardisation without compromising on quality or visual impact
- Damage: the bane of every site professional
- Components arrive in sub assembled form allowing doors to be kept safe until the very last moment before handover
- Reduced risk of errors

Lead times:

- 8 week standard on all products
- Special arrangements available for replacements
- Supported by major factory capacity

Ironmongery:

- Hinges, latches, locks, flush bolts and kick plates are factory fitted as standard. Final fitting of certain other components is required on site to provide installation accuracy and protection from damage

Edge Protection:

- Door edge protection system and resilient PVC door edge lippings available to order

Consistent quality:

- Doorsets all accurately manufactured using advanced machinery. Guaranteed to specification every time



Wide choice within modular range:

- Real wood veneers, natural beauty finished in tough, durable clear lacquer
- Paint finish timber, available primed or finished in a choice of colours
- Veneer effect laminates
- Solid colour laminates
- Choice of lippings including resilient PVC
- Ironmongery: standardised range to suit modular applications

The time and cost saving:

- Save 1 hour on every door installation
- Speeds up fit time by two thirds (See table below)

Door Installation Comparison

Conventional door lining, hanging and swinging	The Doorset; fit and fix
Cut to size, prep and install frame, prep door leaf, fix ironmongery, fix frame, swing door, adjust.	Assemble pre-machined and fitted-out frame, offer up, plumb and square, partially fix, final check, fix permanently, lift on door when ready (final stage before handover).
Total: 1hr 30 mins plus	Total: 30 mins



The Flexible Modular Approach

Typical Doorset that is supplied

The product comes in two major components; door and frame that are wrapped separately. Additional face fitted ironmongery is also supplied separately.

- 1. Pre-machined frame**
Door frame supplied shrink wrapped on delivery, premachined and fitted with hinges and strike plate, head predrilled to accept screws ready to assemble.
- 2. Latch and lock**
Pre-fitted in accurately machined recesses, ready for bolt through handles.
- 3. Factory glazing**
All glass apertures fully glazed with appropriate specification components. Beads retained by tamper resistant screws and cups.
- 4. Hinge**
Hinges pre-fitted, ready for hanging. Optional fixed pin hinges available.
- 5. Severe Duty Core**
Unlike many other Doorsets all our doors are made from Severe Duty Cores tried and tested against wear and tear and built to last. Doors can be supplied as full flaxboard, or with timber sub frame of stile and rail construction, or solid timber lamels.
- 6. Full details of certification**
Specification label details rating and performance of Doorset.



Education, Care Homes, Hotels Hospitals, Retail and Offices

Our Doorset partners include Sweedor, one of the world's largest door manufacturers. These doors are timber based – timber is extremely environmentally friendly and one of a few truly naturally renewable raw materials. Chain of Custody certification schemes are in place, both FSC and PEFC to ensure full compliance where required.

The range of internal doors suit many commercial applications from doors for hotels and residential homes, to student accommodation – as well as schools, offices and retail. Whatever the situation we have a Doorset to suit.

Education

For additional guidance please refer to 'Building schools for the future' section of www.teachernet.gov.uk and follow the links to Standard Specifications, Layouts and Dimensions for School Buildings (SSLD) and refer to 'SSLD7: Internal Doorsets for Schools.'

Legislation and regulations for specification of doors into education buildings is extensive. The main requirements are:

Acoustics

Sound transmission reduction up to 38dB_{Rw}



Fire Safety

Protection of occupants and the fabric of the building of up to 60 minutes, FD30 and FD60.

Security

Schools are frequently the target of theft and arson.

Durability

Heavy duty; frequently used without care and probability of misuse, DD171 other duty levels available.

Sustainability

BREEAM schools requires minimum 'very good' rating. FSC Chain of Custody. Part M, BSEN 8300, DD4. FSC Chain of Custody available.

Zones of visibility

For ease of visibility through the door. DDA and Approved Document M Compliance.

Effective clear opening widths

For ease of access, particularly for wheelchairs. DDA and Approved Document M Compliance.

Opening forces

Ease of opening, DDIT1 EN. DDA and Approved Document M Compliance.

Finger Protection

Especially prevalent in schools to stop pupils damaging their fingers in the Door jambs. Can supply surface mounted or as an integral part of the Doorset (Safehinge).

Position of ironmongery

Ease of use for all heights. DDA and Approved Document M Compliance.

Visual colours and contrasts

Especially relevant for those with impaired sight, 15 points on LRV brightness scale. 30 points complies with Approved Document M (superseded by BS8300:2009 in most applications).

For further information see Doorset Solutions Technical Guide.



Education, Care Homes, Hotels Hospitals, Retail and Offices



Care Homes

Care Homes require doors to meet fire and mobility requirements and often extra wide doors for ease of access for wheelchair users.

Hotels

Veneered doors are ideal as they are available in many finishes to suit any décor – from light oak to mahogany*. Contrasting natural wood and veneer colours can add attractive appearance.

*Mahogany refers to Utile, a specie related to Sapele and closely resembles it in appearance and properties.

Hospitals and healthcare buildings

With many different applications, requiring a variety of performance characteristics and levels, we can offer a Doorset to suit each requirement. Hospital standards are extensively documented and specialist performance products are required for certain applications. This range covers every Doorset configuration and hinge or pivot option needed by integrating into the standard modular range. In addition heavy duty door and frame protection against abuse and physical damage can be added to ensure long term service life.

Offices, retail and specialist applications

Varying from general duty to high performance acoustic and fire resistance, offices and other applications such as studios, media centres, administration facilities, communication centres, as well as transport, entertainment and leisure facilities and many more applications, all have specialist requirements. This modular range sets out to bring value and convenience to specifiers as well as allowing individuality and flair to be expressed in the design and specification.

Veneered Timber Doorsets

George Boyd offers a selection of softwood or hardwood frames in a choice of veneer finishes. These doors are suitable for general use.

- Frames are available in a choice of softwood, pre-primed for site painting, softwood veneered (to match door veneer) or factory painted or factory finished hardwood
- Architraves (optional) are supplied in MDF, pre-primed for site painting
- All doors are crown cut, or quarter cut veneers. Fully factory finished hardwood lippings and glazing beads are also supplied to complement or contrast
- Crown cut veneers are 'book-matched' giving an attractive and continuous matched pattern across the width of the door. 'Booked-matching' takes each veneer slice and joins each edge to the corresponding edge of the next slice, making each group of assembled veneers one continuous attractive pattern



Crown Cut

The log is cut along its length, resulting in a figured appearance. This generally produces a veneer with a central area of a strong figured pattern.



Quarter Cut

The log is cut into four separate quarters. These are then sliced across the growth rings to provide the veneers with a predominantly straight grain producing a vertical striped pattern up the length of the door.



Veneered Timber Doorsets

Frame options	Door options	Size (mm)
Softwood (Un-Primed) Softwood (Fully Painted) Softwood Veneered Hardwood	Veneer	See page 14 for sizing matrix
Oak Maple Beech Ash Utile Koto	Oak Maple Beech Ash Utile Koto	



Crown Cut (book matched)
Crown cut oak veneer, typical of the patterns produced when crown cut.



Quarter Cut
Veneers giving a predominately straight grain pattern.



Factory painted Timber Doorsets

The painted door range provides an extremely practical, hard-wearing and easily cleanable Doorset solution.

Fully factory finished painted doors, provide a highly durable and quality finish, significantly better than can be achieved on-site.

The Timber Doorset offering includes:

- Fully painted doors with a choice of softwood/ hardwood/ veneered softwood frame
- Softwood; fully factory painted to any RAL number (no further finishing required on-site)
- Architraves (optional) in MDF factory primed for finishing on-site
- Colours for doors and frames which can complement or contrast with each other as per your requirements
- Pre-drilled frames and matching PVC pellets are available on request to conceal fixings on paint finished frames (opaque PVC for lacquered hardwood)



Painted Timber Doorsets

Frame options	Door options	Size (mm)
Softwood Sizing Matrix Hardwoods	Primed	See page 14 for Factory Finished
Softwood (Fully Painted)	Fully Painted	See page 14 for sizing matrix



Laminate Faced Doorsets - Veneer Appearance



Laminate doors are favoured in many commercial applications as they are characteristically known for being exceptionally hard-wearing, heavy-duty doors.

- Frames are available in a choice of softwood, veneered softwood or hardwood, pre-primed for site painting or factory painted or clear factory finished hardwood
- Architraves (optional) are supplied in MDF, pre-primed for site painting
- Doors are faced with a laminate from the Formica PSM wood grain effect door ranges and are supplied with hardwood lipped on 2 or 4 edges or high impact PVC (which has excellent impact and moisture resistance)
- Lippings and glazing beads are factory finished
- A laminate finish gives an easy-to-clean and stain resistant surface. Formica Door Collection Range exceeds the requirements of EN438 Test Method 15 (the resistance of v49 everyday substances)

Laminate Faced Doorsets - Veneer appearance and colours

Frame	Door	Size (mm)
Softwood, Pre-Primed, Fully Painted or Factory Finished Hardwood	Formica PSM door collection range either plain colour or wood grain effect	See page 14 for Factory Finished
Oak Maple Beech Ash Utile	Any choice from Formica range	

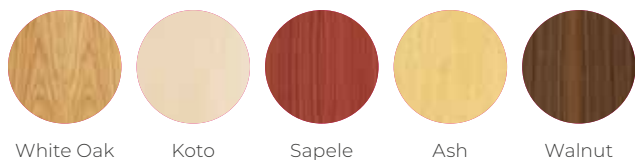

Laminate Timber Doorsets - Colour Range

Available in a vast selection of different colours varying from bright, bold solid colours to subtle tones. These can create unique internal environments, designed for the purpose required.

- Complementary fully factory finished hardwood lippings and glazing beads are also supplied
- Doors are faced with laminate from the plain colour or wood grain effect door ranges and are supplied with hardwood lipped on 2 or 4 edges or high impact PVC (which has excellent impact and moisture resistance)

Additional Doorset Types

- PAS24 / Secure by Design
- Anti-barricade / Anti-ligature
- Postformed / Moisture resistant
- Finger protection
- X-Ray
- Vistamatics

Popular Colours:



Note: The colours shown above represent only a small selection of those colours



Door Dimensions and Diagrams

Standard Modular Door Sizes

	Door Leaf (mm)	Door Frame (mm)	Opening Size (mm)	Clear Opening Widths			Module
				90° 40mm	90° 45mm	180°	
Single	625 x 2052 mm	686 x 2089 mm	710 x 2100 mm	564	559	606	7 x 21 M
	725 x 2052 mm	786 x 2089 mm	810 x 2100 mm	664	659	706	8 x 21 M
	825 x 2052 mm	886 x 2089 mm	910 x 2100 mm	764	759	806	9 x 21 M
	925 x 2052 mm	986 x 2089 mm	1010 x 2100 mm	864	859	906	10 x 21 M
	1025 x 2052 mm	1086 x 2089 mm	1110 x 2100 mm	964	959	1006	11 x 21 M
	1125 x 2052 mm	1186 x 2089 mm	1210 x 2100 mm	1023	1013	1106	12 x 21 M
Unequal Pairs	1225 x 2052 mm	1286 x 2089 mm	1310 x 2100 mm	1123	1113	1206	13 x 21 M
	725 + 398 x 2052 mm	1186 x 2089 mm	1210 x 2100 mm	1023	1013	1106	12 x 21 M
	825 + 398 x 2052 mm	1286 x 2089 mm	1310 x 2100 mm	1123	1113	1206	13 x 21 M
Equal Pairs	925 + 398 x 2052 mm	1386 x 2089 mm	1410 x 2100 mm	1223	1213	1306	14 x 21 M
	725 + 725 x 2052 mm	1513 x 2089 mm	1540 x 2100 mm	1350	1350	1433	15 x 21 M
	825 + 825 x 2052 mm	1713 x 2089 mm	1740 x 2100 mm	1550	1540	1633	17 x 21 M
	925 + 925 x 2052 mm	1913 x 2089 mm	1940 x 2100 mm	1750	1740	1833	19 x 21 M

**Custom sizes also available up to 2.7m frame height

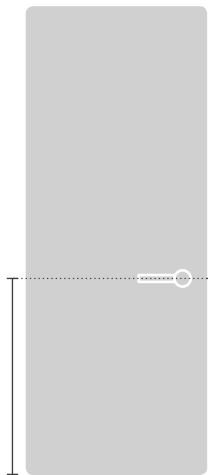
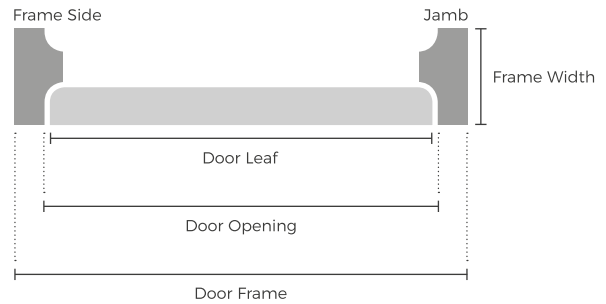
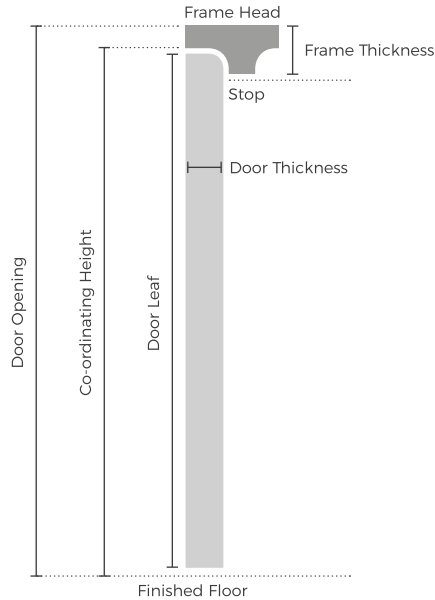

Standard Spindle Height - 900mm

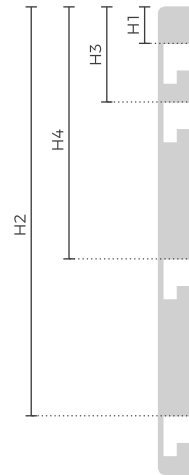

H1 to H3 - Door width to M10
H4 - For door width >M10

Door Dimensions and Diagrams

We offer a range of aperture styles and designs to suit your desired applications.

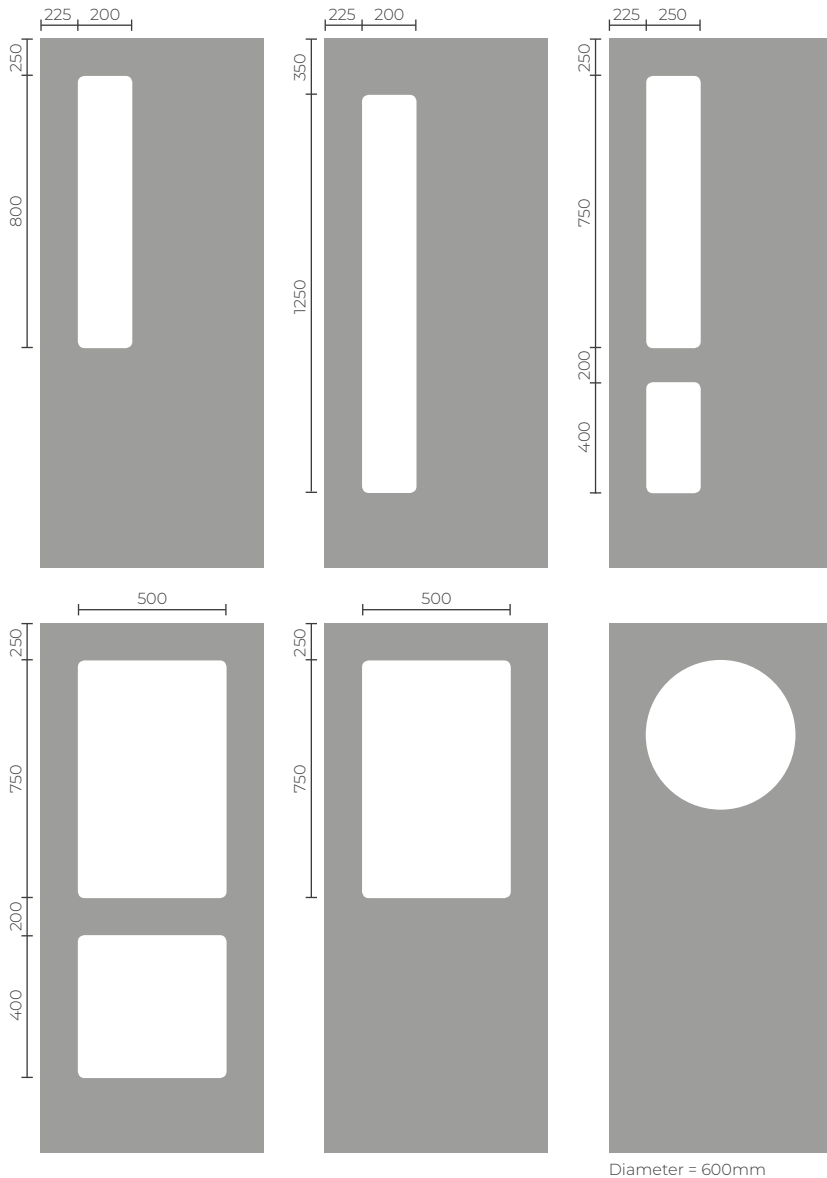

Timber Doorsets vision panel options

To ensure quality and specified performance, all glazed doors are factory glazed with hardwood bolection beads pinned.

Doc M – This indicates that the vision panels comply with document M which requires a zone of visibility between 500mm and 1500mm if necessary interrupted between 800mm and 1150mm above the floor.

Factory glazing:

- Clear laminated/toughened glass
 - non-fire
- Clear safety glass
 - FD30 and FD60

Note: All dimensions are in mm.

**Other vision panel sizes are available

Ironmongery for Timber Doorsets



Stainless Steel Levers

Made from 304 or 316 marine grade stainless steel, our range of stainless steel levers are available either polished to a mirror finish satin to give a brushed effect or a two tone combination of the two. These levers are ideally suited for hospitals and schools alike due to their hardwearing anti corrosion and hygienic properties. Supplied with bolt through fixings and grub screw fixing onto either a HESO or split spindle to give an altogether more robust fixing our range of levers are suitable for high volume high usage areas.

A selection of accessories in matching finishes is also available including door closers, hinges and bathroom fittings.

Available in a variety of designs dependent upon application.

The range of stainless steel furniture is also available in aluminium either SAA or PAA.

Simplan colour Nylon Levers

The Simplan colour range is manufactured from nylon with the lever and pull handles having a steel core. The nylon used is fade resistant, hygienic, stable to chemicals, has good thermal properties and a long life expectancy.

The lever handles have a unique fixing system, which makes them very durable and suitable for heavy duty applications. A selection of accessories in matching colours is also available including door closers, hinges and bathroom fittings.

Lock Case

The 72 series of DIN standard Architectural lockcases comply with latest test requirements of EN12209:2003 EC conformity for heavy duty lock cases.

Door Closers

Whether they are to be installed overhead or concealed our carefully selected range of true cam action range of architectural door closers, when specified by ourselves meet the requirements of BS8300 and Approved Doc M (ADM). Available in a variety of finishes to complement the accompanying ironmongery range, the true cam action range is backed up by a 25-year mechanical guarantee for peace of mind. Our concealed range of door closers will be factory prepared to ensure ease of fitting on site.

Cylinders

The 7 & 8 series Euro profile cylinders comply with EN 1303 for high security and when used in conjunction with the 72 series lock case which complies with EN12209:2003 meets the requirements of BS3621:2007.

We will compile a master key schedule on behalf of the client and offer advice and guidance where necessary; we recommend that our cylinders are supplied with our lock cases to ensure compatibility.

Ironmongery for Timber Doorsets

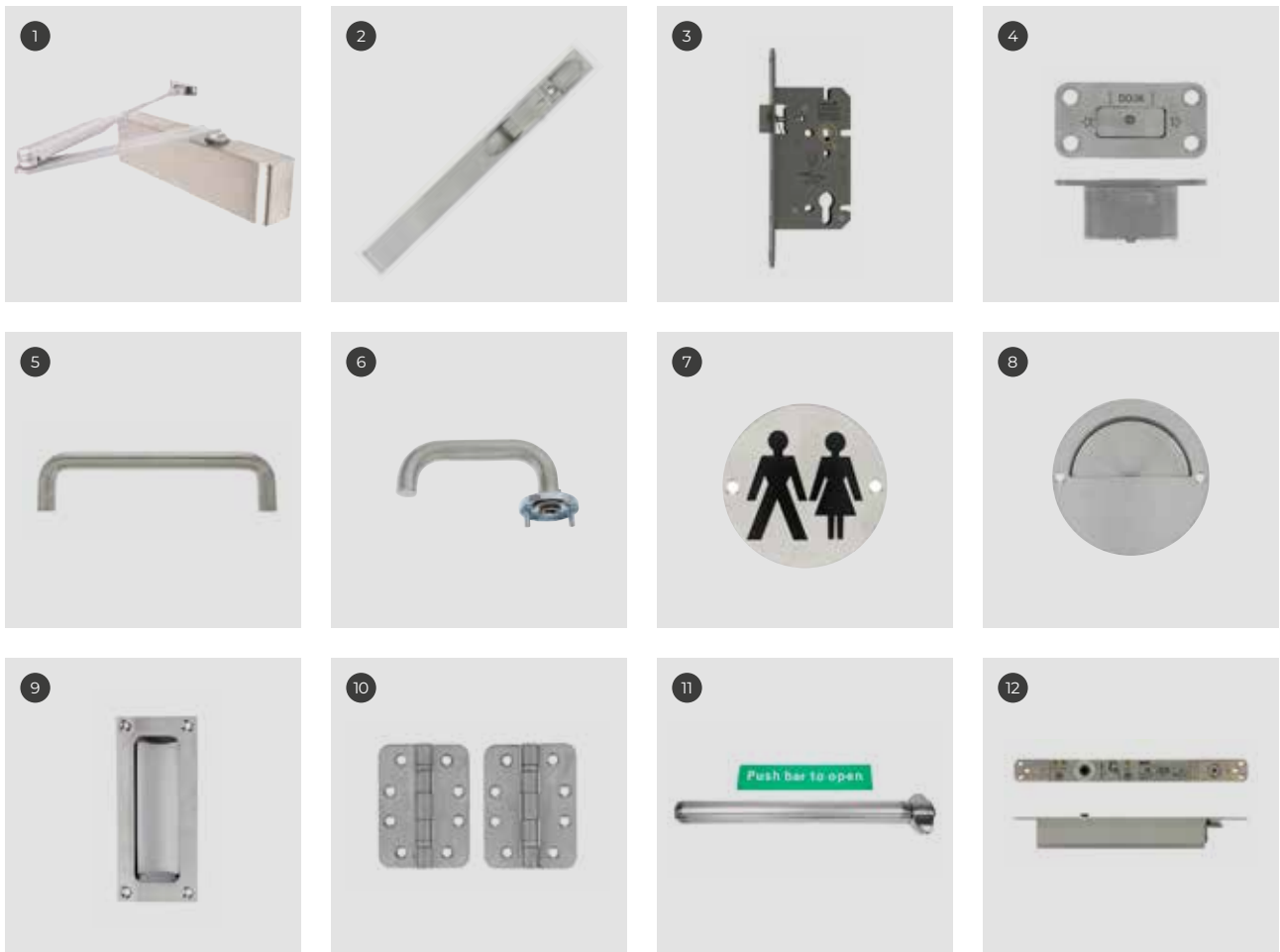

Modular Ironmongery Range

- | | |
|--------------------------------|----------------------------|
| 1. Door Closer | 7. Door Symbol |
| 2. Door Bolt | 8. Door Stop |
| 3. Sashlock | 9. Flush Pull Handle |
| 4. Emergency Release Door Stop | 10. G13 Ball Bearing Hinge |
| 5. Pull Handle | 11. Emergency Exit Bar |
| 6. Stainless Steel Door Handle | 12. Door Closer |

Glazed Steel Profile System

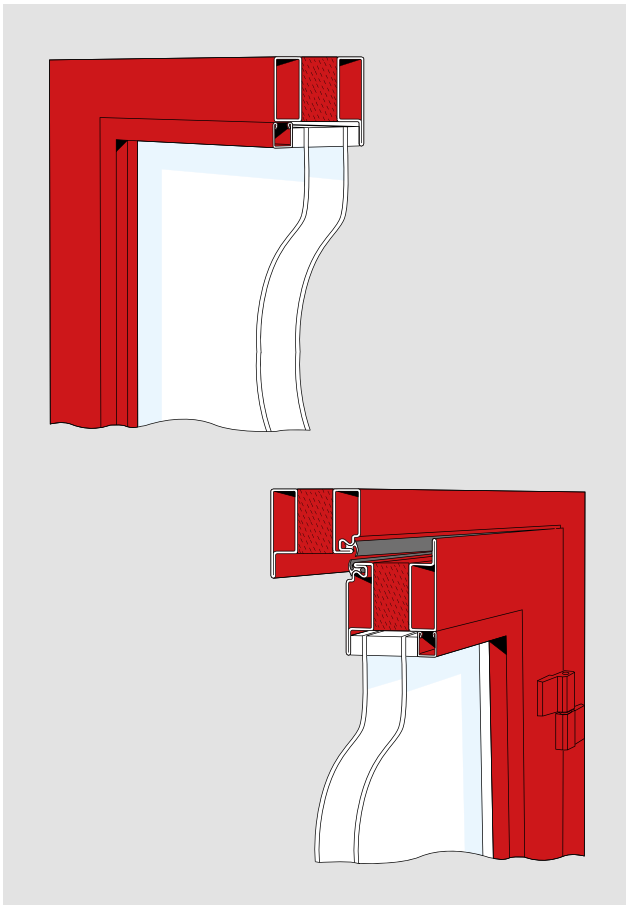

Door and wall sections make up the fire cell partitions in, for example, corridors, main passageways and stairwells used as evacuation routes in the event of a fire. The solid fire-resistant insulating core between the steel profiles effectively reduces heat transfer from the side of the door or wall exposed to the fire.



Glazed Wall Sections
120 minutes fire resistance

These systems are supplied with a core of fire resistant insulation for glazed doors, sliding doors, partition walls and window sections.

Key Benefits of Steel Systems

- Fire resistance up to 2 hours – BS EN 1634-1
- Fire resistant sliding doors up to 30 minutes
- Burglary and bullet resistance
- Arches and round windows available
- Narrow 20mm and wide profiles available: 85, 130, 180 or 260mm
- Finger trap gasket
- All doors fully CE marked with full Declaration of Performance as required by current legislation

Fire Resistance

Up to 2 hours fire resistance. The fire resistant sections in steel have been tested in accordance with BS476: Part 22: 1987. For wall sections up to 120 minutes integrity and insulation, Doorsets up to 90 minutes integrity and 60 minutes insulation as well as double leaf sliding doors with top and side lights for 30 minutes integrity.



Glazed Doorsets
90 minutes fire resistance



Glazed Double Leaf Sliding Doors
30 minutes fire resistance



Size And Configurations

The systems can be adapted to suit requirements and are type approved, with features including finger trap gaskets, round windows and arches. The systems have profiles adapted for modular locks (85mm) as well as narrow (20mm) and wide (130, 180 and 260mm) profiles. These tested and approved systems also come in a wide variety of heights and widths. Wall sections up to 3m height and with a free edge have been tested as per EN 1364-1 to ensure compliance up to EI 120, and 4m height sections up to EI 60.

Unique Fire-Resistant Sliding Door Section

The sliding doors have been tested to a type-approved fire resistant up to fire class EI 30. This provides a max opening of 2210mm for bi-parting sliding doors. Please refer to type approval certificates 1653/96 and 0297/97 as issued by SITAC for more information.

Please note that sliding doors must not be installed along evacuation routes and if required an emergency exit door should be installed at the side.

Combined Fire And Security Resistance

In addition to requirements for fire resistance, glass must also comply with requirements for burglary resistance as per EN 356 as well as fittings. Type-approved solutions include, among other things, multipoint locks (MPL). Glazed systems are type-approved for several fire-resistant classes in combination with burglary resistance, e.g. EI 60 and RC 4. Fire resistance is provided in accordance with the applicable type approval certificate. Burglary-resistance classes RC 3 and RC 4 are in accordance with standard ENV 1627.



External Steel Doors



Steel Doorsets are designed to provide additional security in a variety of applications. Doors are supplied with protection astragal formed flush as part of the outside face of the door leaf, this allows them to perform consistently in terms of security and function.

Key Benefits of Steel Systems

- Doors are made to measure
- The doors are made to order in 10mm increments
- The doors range from 690mm – 1340mm for wide single doors. The sizes for our wide double doors are 1000mm – 2600mm, whilst our high doors come in sizes 1500mm – 2800mm

Security

In the event of an attack upon the door, the frame (or on double doors the inactive leaf) has a step in its edge to ensure that the astragal sits flush. Unlike other doors on the market that have no astragal or joggled astragals, the doors make it increasingly difficult for attackers to break through.

The doors are also hung on four stainless steel hinges, complete with dog bolts and four fixing points per side, sitting behind the door leaf. This ensures that the doors are protected whether they are fitted as inward or outward opening. We also offer variable sub-frames to the doors, covering the gap between the building structure and the main door frame; further measures to ensure the door continues to perform to the utmost level of security.

Durability

The steel doors come fully assembled with hardware fitted; this includes adjustable fixing feet and variable sub-frames. This drastically reduces the installation time on site, which adds value to any project. As opposed to the cost and installation of timber products, steel doors offer great cost savings and a much easier installation process. Furthermore, the durability of steel ensures that the doors can withstand high levels of damage, be it from high traffic areas or even potential abuse.

Finishes

We can offer our external doors either primer finished, powder coated or wet spray finished and can also pattern the door blade from a range of designs to allow for a more traditional aspect to the Doorset. We also have a range of attractive wood grain PVC laminates which offer the traditional look of timber with the modern durability of steel.

Standard

1. Polyester powder coated from standard colour range

Optional

2. Polyester powder coated from now standard colour range
3. Stainless Steel brushed, polished or patterned
4. Unfinished for site finishing

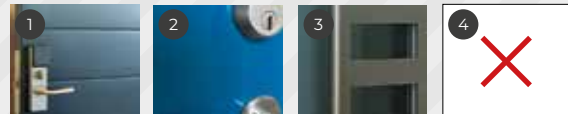

Designs

Dependent upon the doors application a variety of panel arrangements can be chosen from including vision and louvre options.

Vision Panels

254x254mm
254x1219mm

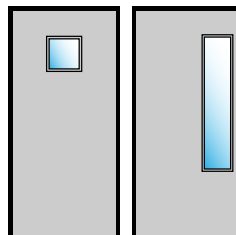

Louvre Panels

457x457mm
457x1524mm

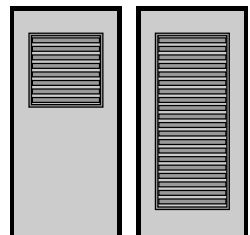

Panel Arrangements

Single Door and side panel
Double Doors and Over panel

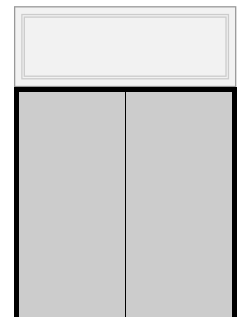
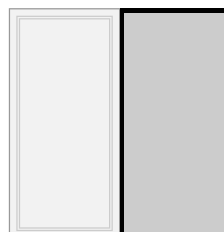

Sound Reduction



Acoustic rated Doorsets require accurate sealing and installation to achieve the desired performance.

Threshold seals are essential and two alternative seals are provided. Acoustic performance also depends on the elimination of all passages of sound transmission and any gap between the back of the door frame and the wall must be fully sealed using mineral fill.

Typical Sound Reduction Graph

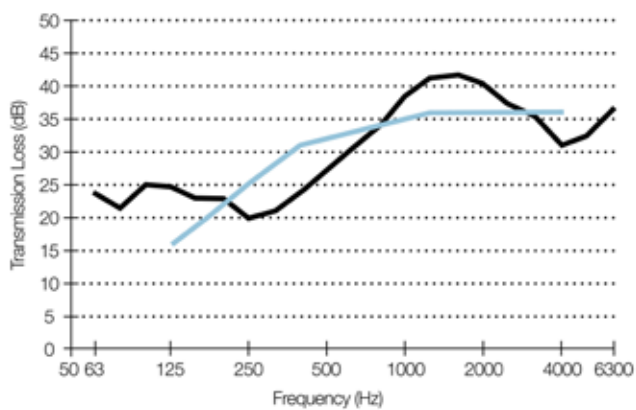

= Reference Curve = Sample Curve

dBRw values are stated at the 500Hz frequency, comparing the sample curve with the reference curve. The value represents the difference between the two curves at this frequency.

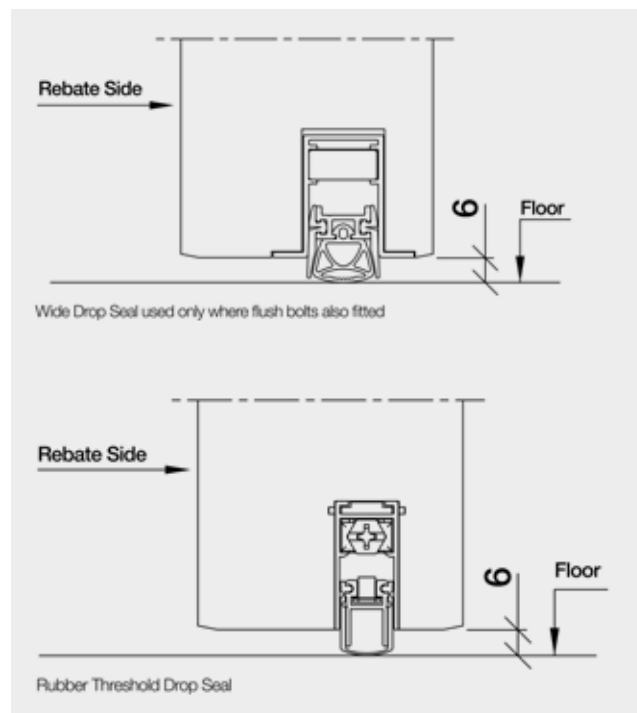

PQQ and Tendering, Scheduling, Order Processing, Protection, Finish, Appearance, Installation, After Care Sales

George Boyd provides a wide range of support and services to its customers to make all aspects of doing business as convenient and reliable as possible.

Pre Qualification Questionnaires (PQQ) and Invitations to Tender (ITT) requirements

George Boyd and its partners have a long established team dedicated to getting the best from each enquiry received and in particular has detailed information available to support new business opportunities.

Scheduling

Essential for the smooth running of every contract, effective scheduling of deliveries is critical. George Boyd and its partners provide this service and ensure full visibility of the schedules for the customers to share. Where any adjustments are required these must be made ahead of the 8 week lead time described above, essential to maintain the excellent service that we strive to maintain at all times. Unless otherwise arranged, the customer will be notified of expected delivery day during the week preceding the delivery. Failed deliveries will be held for later delivery with a handling and storage charge made, dependent on delay.

Order processing and control

On receipt of every order it is thoroughly checked and verified against our quotation and other information supplied by the customer. Any queries will be raised promptly and any amends made before the order is 'Set'. Once 'Order Setting' has taken place (normally 5 working days from receipt), no further amends are possible and the order is 'Locked' into the factory process. Standard delivery period is 8 weeks from receipt of confirmed order which includes the setting process.

Protection

Packaging should not be removed until the products need to be installed, remembering that they are a late second fix. Under no circumstances should any tape, including 'low-tack' be applied to the Doorset surface as solvents may react with the finish and cause damage.

Finish

Where products are supplied partially finished the initial coat of primer or clear sealer may tend to raise the grain of the timber and will require flattening on-site with a fine abrasive before further coats are applied.

Appearance

As a natural material, hardwoods used for frames, lippings and beads can vary in colour from its equivalent veneer. Occasionally, lighter colour sapwood or resin pockets may be present – this is a natural feature and not a defect.



After Care and Sales

George Boyd provides specialised national coverage for all mainland UK customers in case of any complaint or site service requirement. Where justified, this is entirely free of charge but where customers require assistance because of factors outside George Boyd's control, a charge may be made.

Where replacement products are required, for whatever reason, George Boyd's operates a priority manufacturing service to get these to site without the normal lead time being required.

Saint-Gobain Environmental Commitment

As a large group made up of 34 brands in the UK & Ireland embedding our CSR strategy into day-to day operations, plans and business culture is fundamental to our success.

Saint-Gobain UK and Ireland is one of 14 worldwide delegations that extend from our central Group, which is headquartered in Paris. In the UK and Ireland, we operate in three sectors:

- Construction Products, including gypsum, insulation, mortar, ductile pipes and fittings
- Innovative Materials, including flat glass and high performance materials
- Building Distribution, including general builders and plumbers merchants and a wide variety of specialist materials distributors including George Boyd



OUR FOUR PILLARS OF FOCUS

The Group CSR strategy and targets provide the foundation for our CSR approach, activities and management. Saint-Gobain UK and Ireland’s CSR programme is built on four pillars:

<p>Improving People’s Lives By Creating Comfortable Buildings</p> <p>We have developed an innovative Multi Comfort concept based around different types of comfort including: thermal, acoustic, visual and air quality. This standard is a key concept that demonstrates how we can create great living places that improve users well-being, productivity, learning and recovery. Our first pillar is focussed on improving the lives of everyone by creating better buildings and helping provide the skills the industry needs. Find out more at multicomfort.co.uk</p>	<p>Supporting And Developing Our People</p> <p>Staff training and development, health and safety, and wellbeing are prioritised at Saint-Gobain UK and Ireland and we’re proud to be again recognised as a Top Employer. We publish data on training, mobility, diversity and employee well-being which are important indicators of our progress. To find out more please see: saint-gobain.co.uk/csr/our-performance</p>	<p>Caring For The Environment We Operate Within</p> <p>In addition to targets to reduce waste, water use and emissions we are committed to long term change that helps to tackle climate change and support the UN’s Sustainable Development Goals, in particular SDG 9: industry, innovation and infrastructure; and SDG 13: climate action. We are increasing the recycled content of our materials and are developing a number of programmes to recover waste materials from the industry for re-use in our manufacturing process.</p>	<p>Connecting With Our Communities And Supporting Their Economic Development</p> <p>We encourage our colleagues to get involved in communities. To join partnerships with schools, colleges and universities, to undertake local procurement, support our charity partner and local businesses. We are also focussed on supporting entrepreneurs to develop their business and creating partnerships with others to develop construction skills.</p>
---	---	--	---

The full George Boyd Architectural Ironmongery range is available from:



Dundee

119 Clepington Road,
Dundee,
DD3 7NU

Tel: 01382 458918

Fax: 01382 462967

Email: branch4502@george-boyd.co.uk

Kirkcaldy

5 Randolph Place,
Randolph Ind Estate,
Kirkcaldy,
KY1 2YX

Tel: 01592 650055

Fax: 01592 650228

Email: branch4501@george-boyd.co.uk

Glasgow East

300 Crownpoint Road,
Bridgeton,
Glasgow,
G40 2UP

Tel: 01415 506100

Fax: 01415 506118

Email: glasgow@george-boyd.co.uk

Leicester

111 Cannock Street,
Leicester,
LE4 9HR

Tel: 01162 762783

Fax: 01162 762994

Email: branch4510@george-boyd.co.uk

Aberdeen

Unit 2, Quarry Road,
Northfield,
Aberdeen,
AB16 5UU

Tel: 01224 685541

Fax: 01224 682518

Email: branch4506@george-boyd.co.uk

Glasgow West

Unit 3A, 780 South Street,
Whiteinch,
Glasgow,
G14 0SY

Tel: 01419 545051

Fax: 01419 547322

Email: branch4500@george-boyd.co.uk

Malton

Showfield Ind Estate,
Malton,
North Yorkshire,
YO17 6BT

Tel: 01653 690011

Fax: 01653 690060

Email: branch4515@george-boyd.co.uk

Crawley

Unit 11 Whittle Way,
Crawley,
West Sussex,
RH10 9RW

Tel: 01293 539919

Fax: 01293 538790

Email: branch4507@george-boyd.co.uk

Hamilton

Unit 5 Block 6,
Fullwood Ind Estate,
Hamilton,
ML3 9AZ

Tel: 01698 458188

Fax: 01698 458199

Email: branch4517@george-boyd.co.uk

Sunderland

Carrmere Road,
Leechmore Ind Estate,
Sunderland,
SR2 9TW

Tel: 01915 236773

Fax: 01915 236392

Email: branch4514@george-boyd.co.uk

Darlington

Lingfield Way,
Yarm road Industrial Estate,
Darlington,
DL1 4ZP

Tel: 01325 394250

Fax: 01325 381965

Email: branch4511@george-boyd.co.uk

Hull

Cobblestone Park,
Foster Street,
Hull,
HU8 8BT

Tel: 01482 589989

Fax: 01482 589444

Email: branch4516@george-boyd.co.uk

George Boyd

Distribution Centre

25 Loanbank Quadrant,
Glasgow,
G51 3HZ

Tel: 01414 457092

Fax: 01414 457091

Email: GBDC@george-boyd.co.uk

Whilst every care has been taken to ensure that the information included in this document was accurate at the time of printing, we reserve the right to change specifications at any time. All drawings, photographs, product numbers, layout and style are considered property; reproduction in whole or in part, is strictly prohibited without written permission. Quantities, dimensions and measurement are approximate. Exact products may vary from that shown. All products listed are subject to availability.

Jewson Limited trading as George Boyd.
Registered Office: Saint-Gobain House, Binley Business Park, Coventry CV3 2TT.
Registered in England and Wales No. 348407.

For further information contact Central Sales on 0845 66013547.